

## HIGHWAYS ACT 1980

### THE COUNTY OF HEREFORDSHIRE DISTRICT COUNCIL

#### THE COUNTY OF HEREFORDSHIRE DISTRICT COUNCIL (SOUTH WYE TRANSPORT PACKAGE – A4194 SOUTHERN LINK ROAD) (CLASSIFIED ROAD) (SIDE ROADS) ORDER 2018

The County of Herefordshire District Council ("the Council") make this Order in exercise of their powers under sections 14 and 125 of the Highways Act 1980 and all other powers enabling them in that behalf:-

(1) The Council are authorised in relation to the classified road in the County of Herefordshire to:

- (a) improve the lengths of highway named in the Schedules to this Order and shown on the corresponding Site Plan by cross hatching;
  - (b) stop up each length of highway described in the Schedules and shown on the corresponding Site Plan by zebra hatching;
  - (c) construct a new highway along each route whose centre line is shown on the Site Plans by an unbroken black line surrounded by stipple;
  - (d) stop up each private means of access to premises described in the Schedules and shown on the corresponding Site Plan by a solid black band; and
  - (e) provide new means of access to premises at each location shown on the Site Plans by thin diagonal hatching.
- (2) Where a new highway is to be constructed wholly or partly along the same route as a new access or part of one, that new highway shall be created subject to the private rights over that new access.
- (3) Each new highway is given a reference letter on a Site Plan, which is also placed in the respective Schedule, and will be a road unless the word "footpath", "bridleway" or "cycle track" appears beneath its reference letter in that Schedule, in which case it will be a footpath, bridleway or cycle track (as the case may be). Each new access is given a number on a Site Plan, which is also placed in the respective Schedule.
- (4) Where a new highway is to be constructed or a new access is to be provided in connection with the stopping up of a length of highway or private means of access described in a Schedule, its reference letter or number (as the case may be) is placed in that Schedule opposite the description of that length.
- (5) Each Site Plan shows the works indicated in the respective Schedule and has the same number as that Schedule, and the route of the classified road in relation to those works.

2. Where immediately before a length of highway is stopped up in pursuance of this Order there is under, in, on, over, along or across that highway any apparatus of statutory undertakers or any telecommunications code system operator then, subject to section 21 of the Highways Act 1980, those undertakers, or that operator, as the case may be, shall have the same rights as respects that apparatus as they had immediately before the stopping up took place.

3. In this Order:

- (a) distances are measured along the route of the relevant highway or private means of access to premises, as the case may be;
- (b) a reference to a Schedule or Site Plan number is a reference to the Schedule, or to the Site Plan, so numbered;
- (c) "the classified road" means the highway which the Council propose to construct from a point on the 84349 Clehonger Road at Dunan Lodge for a total distance of 3.6 kilometres initially in an easterly direction to A465 Abergavenny Road and then in a southerly direction to A49 Ross Road and which is a highway/proposed highway which is a classified road in accordance with section 12 of the Highways Act 1980;

"the Council" means the County of Herefordshire District Council;

"improvement" in relation to a highway includes raising, lowering or otherwise altering that highway, and "improved" shall be construed accordingly;

"new access" means a means of access to premises authorised by this Order to be provided;

"new highway" means a highway authorised by this Order to be constructed and "new highways" shall be construed accordingly;

"Schedule" means a Schedule to this Order, and "Schedules" shall be construed accordingly;

"the Site Plan" means one of the plans numbered 1 and 2 contained in the Plan Folio marked "The County of Herefordshire District Council (South Wye Transport Package – Southern Link Road) (Classified Road) (Side Roads) Order 2018" sealed with the Common Seal of the Council and deposited at the offices of the Council at Blueschool House, Blueschool Street, Hereford HR 1 2LX; and a duplicate has been deposited in the Offices of the Secretary of State for Transport and may also be viewed online at <https://www.herefordshire.gov.uk>

## SCHEDULE 1

In the Parish of Clehonger in the County of Herefordshire

Site Plan 1 of 2

Drawing No. OD33-01\_Hereford – SLR) SRO-A1\_SRO

### Highways to be improved

B4349, Clehonger Road --

Junction with B4349, Clehonger Road --

and A465, Abergavenney Road. --

(See inset 'C' on attached plan).

Golden Post Road leading to Pykeways --

A465, Abergavenney Road --

### Highways to be stopped up

B4349, Clehonger Road from a point leading in an easterly direction from Copper Beeches for approximately 397 metres and ending at Forest View.

Golden Post Road from a point leading to the southeast of Copper Beeches and proceeding for a distance of 175 metres and ending at property known as Pykeways

A465, Abergavenney Road from a point 65 metres in a north easterly direction from Golden Post Cottage for a distance of 99 metres.

Public Footpath No. CH9 from a point 13 metres in a south westerly direction proceeding from Copper Beeches for a distance of 33 metres.

### Reference letters of new highways

--

--

--

--

--	A (bridleway)
--	B (bridleway)
--	C (footpath)
--	D (footpath)
--	E (footpath)
--	F (footpath)

**Private means of access to be stopped up**

**Reference numbers of new accesses**

Access north east of Copper Beeches (see Insert A) (a)	1
Access to field 33 metres southwest of the main entrance to Copper Beeches. (b)	2
Access to field 12 metres from a point at its junction with Copper Beeches and Clehonger Road. (c)	3
--	4
--	5
--	6
--	7
--	8
--	9
--	10
--	11

**SCHEDULE 2**

In the Parish of Callow and Haywood Group in the County of Herefordshire

Site Plan 2 of 2

Drawing No. OD33-05\_Hereford-SLR\_SRO-A1\_SRO

**Highways to be improved**

Haywood Lane, north east of Haywood Lodge Cottages

--

Grafton Lane from a point starting at the Green Inn and heading in a northerly direction for a distance of 93 metres ending south of Ashley Farm.

--

**Highways to be stopped up**

**Reference letters of new highways**

Public Footpath No. HA3 heading in a south easterly direction and leading for a distance of 528 metres.

--

Public Footpath No. HA7 in an easterly direction from Roman Byre for a distance of 420 metres ending at Haywood Lane.

--

Public Footpath No. GF3 from a distance of 560 metres proceeding in a north westerly direction from Grafton Wood and leading and ending southwest of Cedar Folly

--

--

G  
(bridleway)

--

H  
(bridleway)

**Private means of access to be stopped up**

**Reference letters of new accesses**

Access to field off Haywood Lane leading to Beech Grove (d)

12

--

13

PLAN FOLIO

THE COUNTY OF HEREFORDSHIRE DISTRICT  
COUNCIL(SOUTH WYE TRANSPORT PACKAGE – A4194  
SOUTHERN LINK ROAD) (CLASSIFIED ROAD) (SIDE  
ROADS) ORDER 2018

PLAN SYMBOLS

CLASSIFIED ROAD

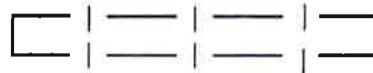

NEW HIGHWAY



HIGHWAY TO BE IMPROVED



HIGHWAY TO BE STOPPED UP



PRIVATE MEANS OF ACCESS TO BE  
STOPPED UP



NEW MEANS OF ACCESS



CONTENTS:  
KEY PLAN, SITE PLANS

These site plans show the routes of new highways, the sites of improvement, stopping up and new accesses, but no widths or construction details.

KEY PLAN SCALE 1:5000  
SITE PLANS SCALE 1:2500

The COMMON SEAL OF THE  
COUNTY OF HEREFORDSHIRE  
DISTRICT COUNCIL

was hereunto affixed in the  
presence of

.....*D.L. Gwyn*.....

Authorised Officer

Dated: 5th March 2018



**THE COMMON SEAL of THE  
COUNTY OF HEREFORDSHIRE  
DISTRICT COUNCIL**  
was hereunto affixed in the  
presence of :



*D. L. Cole*  
.....  
Authorised Officer

Date... *5th March 2018* .....



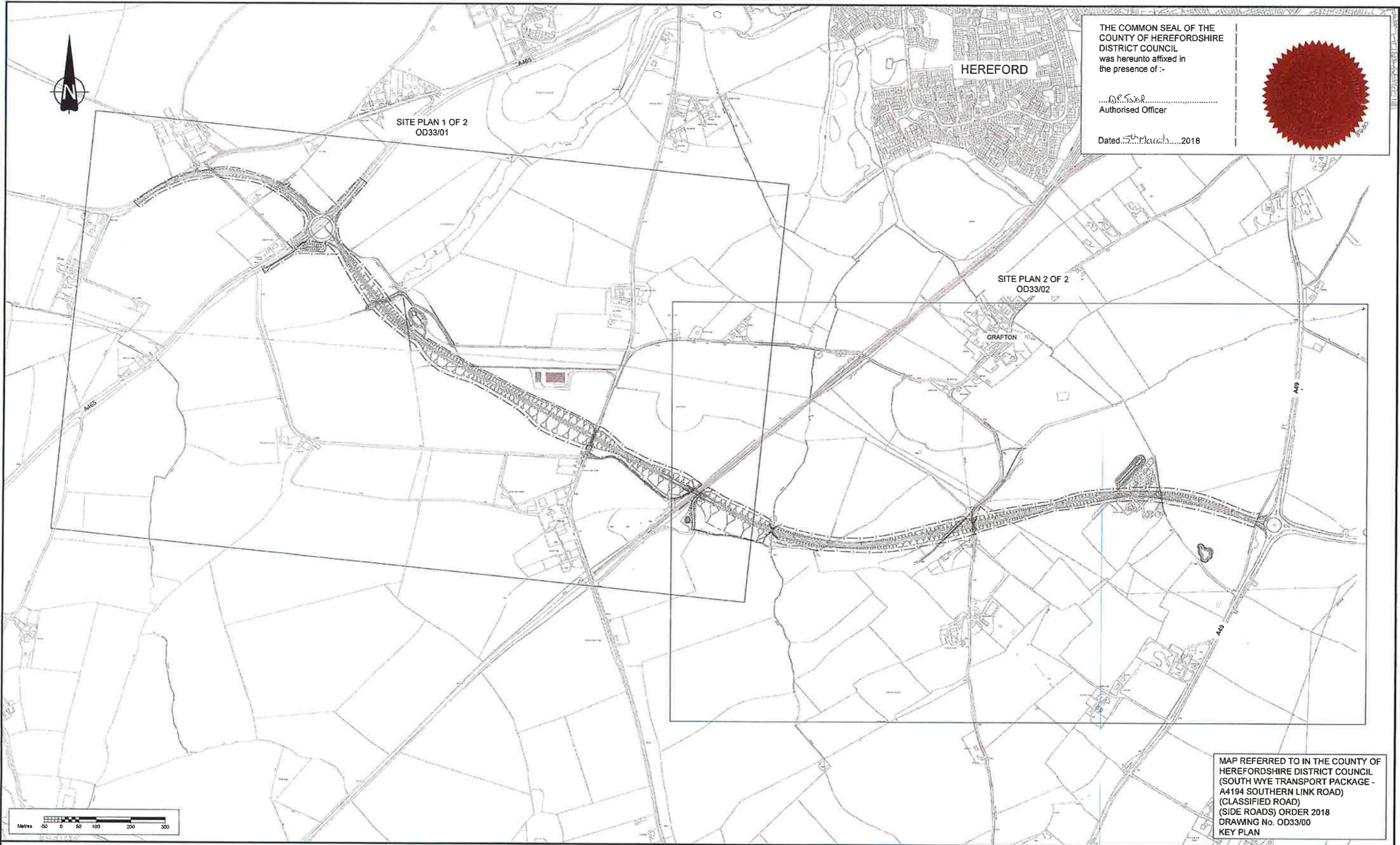

THE COMMON SEAL OF THE  
 COUNTY OF HEREFORDSHIRE  
 DISTRICT COUNCIL  
 was hereunto affixed in  
 the presence of :-

*[Signature]*  
 Authorised Officer

Dated *5th March* 2018



MAP REFERRED TO IN THE COUNTY OF  
 HEREFORDSHIRE DISTRICT COUNCIL  
 (SOUTH WYE TRANSPORT PACKAGE -  
 A4194 SOUTHERN LINK ROAD)  
 (CLASSIFIED ROAD)  
 (SIDE ROADS) ORDER 2018  
 DRAWING No. OD33/00  
 KEY PLAN

© Crown Copyright and database rights 2018 OS [100024168]  
 This map is reproduced from Ordnance Survey material with the  
 permission of Ordnance Survey on behalf of the Controller of Her  
 Majesty's Stationery Office.  
 Unauthorised reproduction infringes Crown copyright and may  
 lead to prosecution or civil proceedings.

Scale 1:5000 @A1  
 1:10000 @A3



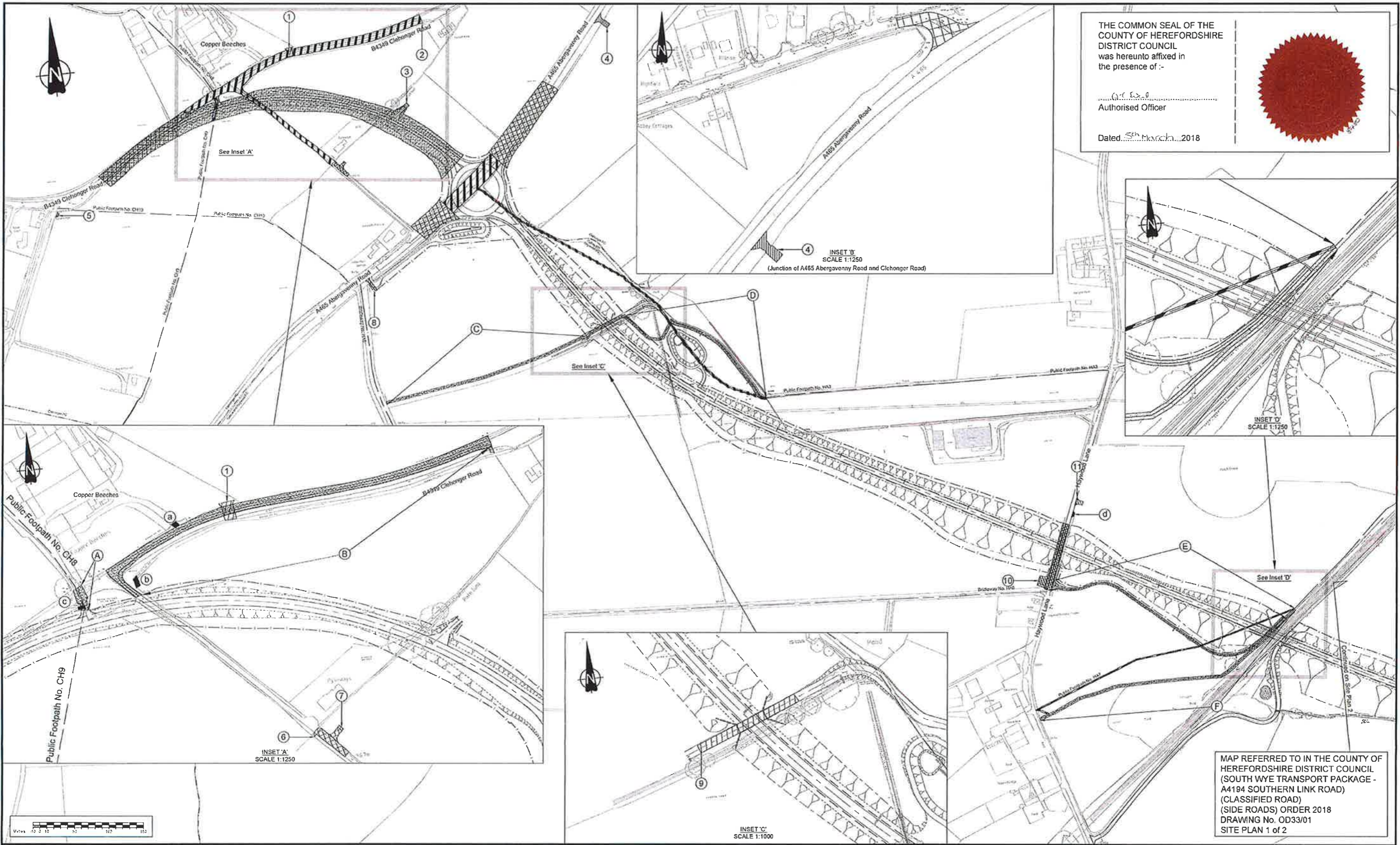

THE COMMON SEAL OF THE COUNTY OF HEREFORDSHIRE DISTRICT COUNCIL was hereunto affixed in the presence of :-

.....  
 Authorised Officer

Dated...5th March...2018



© Crown Copyright and database rights 2018 OS (100024168)  
 This map is reproduced from Ordnance Survey material with the permission of Ordnance Survey on behalf of the Controller of Her Majesty's Stationery Office.  
 Unauthorised reproduction infringes Crown copyright and may lead to prosecution or civil proceedings.

MAP REFERRED TO IN THE COUNTY OF HEREFORDSHIRE DISTRICT COUNCIL (SOUTH WYE TRANSPORT PACKAGE - A4194 SOUTHERN LINK ROAD) (CLASSIFIED ROAD) (SIDE ROADS) ORDER 2018  
 DRAWING No. OD33/01  
 SITE PLAN 1 of 2

Scale 1:2500 @A1  
 1:5000 @A3



